

# HUD Mining Supplies (Pty) LTD

Physical: 58 Director Road, Spartan  
Postal: Postnet Suite 99, Private Bag X10010, Edenvale 1610  
Telephone: +27 11 974 1500 Fax: +27 11 974 1506  
Email: [info@hud.co.za](mailto:info@hud.co.za)



## Product Brochure

# Kempe U2-AW Hydraulic Diamond Drill



| Title   | Date           | By             | Sign | Approved       | Sign |
|---|----------------|----------------|------|----------------|------|
| <b>Kempe U2-AW Hydraulic<br/>Diamond Drill Brochure</b> | <b>21.7.09</b> | <b>I Omand</b> |      | <b>D Huddy</b> |      |
| Revision  | Date           | By             | Sign | Approved       | Sign |
| <b>HUD Design Original</b>                              |                |                |      |                |      |

## U2-AW Hydraulic Diamond Drill Specifications

|                           |   |  |                        |     |            |     |            |
|---------------------------|---|--|------------------------|-----|------------|-----|------------|
| <b>Rating</b>             | 100 m ex (horizontal). AXT (48mm)   |  |                        |     |            |     |            |
| <b>Spindle speed</b>      | 0 - 900 rpm, infinitely variable  |  |                        |     |            |     |            |
| <b>Weight drill</b>       | 45 kg   |  |                        |     |            |     |            |
| <b>Motor</b>              | Hydraulic   |  |                        |     |            |     |            |
| <b>Power Pack</b>         | 22kW electric motor with variable displacement hydraulic pump.  |  |                        |     |            |     |            |
| <b>Controls</b>           | Free standing console incorporating controls for drilling, rod pulling and pushing, with 4m hose from controls to the drill-head  |  |                        |     |            |     |            |
| <b>Operating pressure</b> | 21MPa   |  |                        |     |            |     |            |
| <b>Feed screw</b>         | ID suitable for E, A, or AQ rods  |  |                        |     |            |     |            |
| <b>Feedscrew run</b>      | 610 mm  |  |                        |     |            |     |            |
| <b>Chuck</b>              | 3 jaw suitable for E, A, or AQ rods   |  |                        |     |            |     |            |
| <b>Drill</b>              | Totally enclosed unit containing all moving parts including the motor. The brackets on the main housing are designed for right hand mounting.   |  |                        |     |            |     |            |
| <b>Feed gears</b>         | The machine is equipped with 2 feed gears, with available selection as follows:<br><br>Revolutions per inch advance<br><table> <tr> <td></td> <td><b>Standard Config</b></td> </tr> <tr> <td>205</td> <td><b>347</b></td> </tr> <tr> <td>447</td> <td><b>608</b></td> </tr> </table> <p>In all cases the same feed gears are used. One set of input gears is changed to give different feed ranges.</p> |  | <b>Standard Config</b> | 205 | <b>347</b> | 447 | <b>608</b> |
|                           | <b>Standard Config</b>  |  |                        |     |            |     |            |
| 205                       | <b>347</b>  |  |                        |     |            |     |            |
| 447                       | <b>608</b>  |  |                        |     |            |     |            |
| <b>Feed gear change</b>   | Interlock system. Neutral / reverse position located between each gear. Holding the handwheel while in neutral will reverse the feed screw.   |  |                        |     |            |     |            |
| <b>Saddle plate</b>       | Designed to take a single rod puller.   |  |                        |     |            |     |            |
| <b>Mounting</b>           | Clamp to fit 114mm (4 ½") OD single bar.  |  |                        |     |            |     |            |
| <b>Angle of drilling</b>  | Designed to drill through 360°.   |  |                        |     |            |     |            |
| <b>Rod puller</b>         | Hydraulic rod puller with inter connecting hoses  |  |                        |     |            |     |            |
| <b>Puller mechanism</b>   | Non-slip double-ended ball type with turrets on either side to facilitate pushing or pulling. Available for E, A, or AQ rods  |  |                        |     |            |     |            |



Typical Assembly

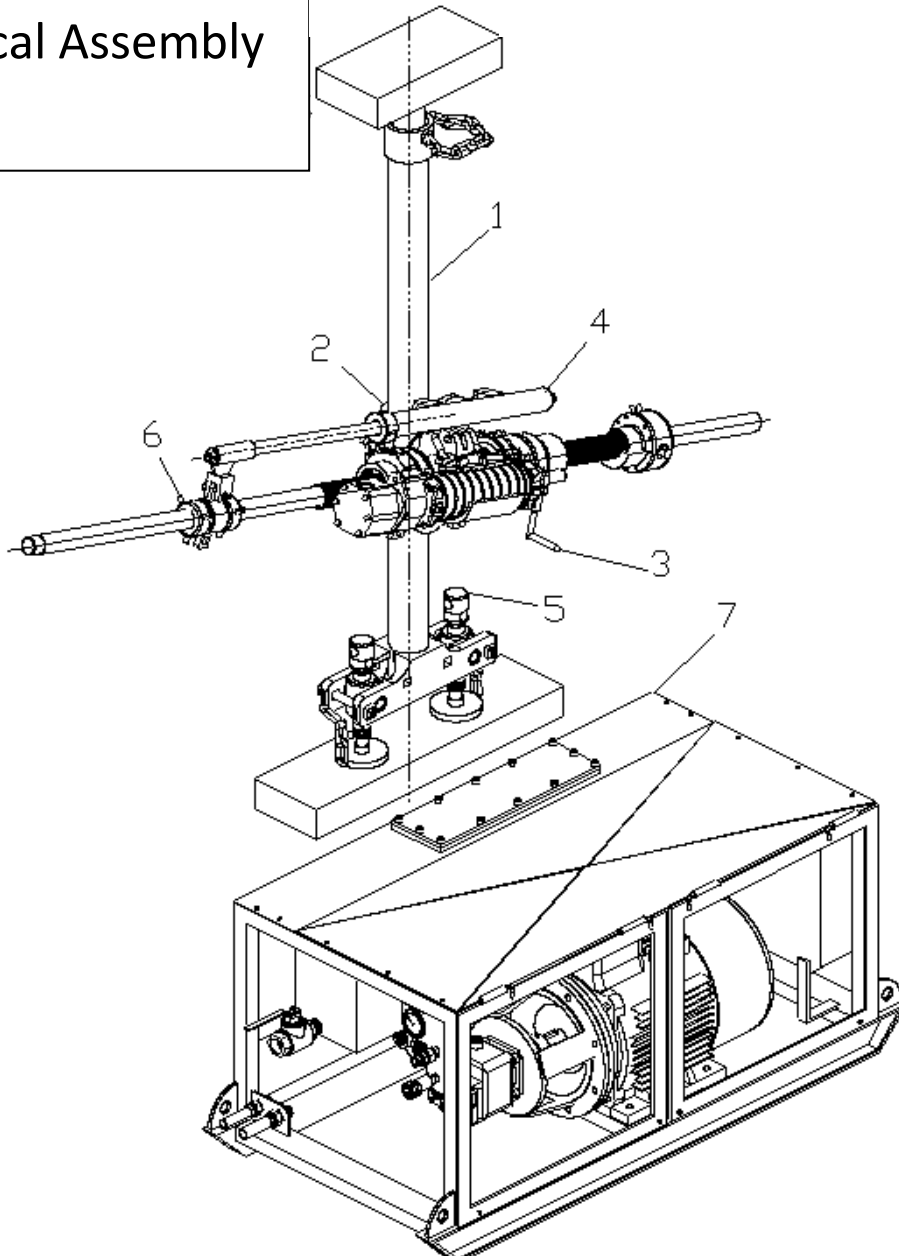

| IT | DESCRIPTION              | QTY |
|----|--------------------------|-----|
| 0  | DRILL RIG COMPLETE       | 1   |
| 1  | TELESCOPIC POLE ASSEMBLY | 1   |
| 2  | POLE CLAMP ASSEMBLY      | 1   |
| 3  | DRILL UNIT ASSEMBLY      | 1   |
| 4  | STANDARD HYD. ROD PULLER | 1   |
| 5  | DOUBLE JACK ASSEMBLY     | 1   |
| 6  | BALL ROD PULLER ASSEMBLY | 1   |
| 7  | HYDRAULIC POWER PACK     | 1   |
| 8  |                          |     |

