

HUD Mining Supplies (Pty) LTD

Physical: 58 Director Road, Spartan
Postal: Postnet Suite 99, Private Bag X10010, Edenvale 1610
Telephone: +27 11 974 1500 Fax: +27 11 974 1506
Email: info@hud.co.za



Product Brochure

Kempe U2-AW Hydraulic Diamond Drill



Title	Date	By	Sign	Approved	Sign
Kempe U2-AW Hydraulic Diamond Drill Brochure	21.7.09	I Omand		D Huddy	
Revision	Date	By	Sign	Approved	Sign
HUD Design Original					

U2-AW Hydraulic Diamond Drill Specifications

Rating	100 m ex (horizontal). AXT (48mm)								
Spindle speed	0 - 900 rpm, infinitely variable								
Weight drill	45 kg								
Motor	Hydraulic								
Power Pack	22kW electric motor with variable displacement hydraulic pump.								
Controls	Free standing console incorporating controls for drilling, rod pulling and pushing, with 4m hose from controls to the drill-head								
Operating pressure	21MPa								
Feed screw	ID suitable for E, A, or AQ rods								
Feedscrew run	610 mm								
Chuck	3 jaw suitable for E, A, or AQ rods								
Drill	Totally enclosed unit containing all moving parts including the motor. The brackets on the main housing are designed for right hand mounting.								
Feed gears	The machine is equipped with 2 feed gears, with available selection as follows: <table> <tr> <td>Revolutions per inch advance</td> <td></td> </tr> <tr> <td></td> <td>Standard Config</td> </tr> <tr> <td>205</td> <td>347</td> </tr> <tr> <td>447</td> <td>608</td> </tr> </table> <p>In all cases the same feed gears are used. One set of input gears is changed to give different feed ranges.</p>	Revolutions per inch advance			Standard Config	205	347	447	608
Revolutions per inch advance									
	Standard Config								
205	347								
447	608								
Feed gear change	Interlock system. Neutral / reverse position located between each gear. Holding the handwheel while in neutral will reverse the feed screw.								
Saddle plate	Designed to take a single rod puller.								
Mounting	Clamp to fit 114mm (4 ½") OD single bar.								
Angle of drilling	Designed to drill through 360°.								
Rod puller	Hydraulic rod puller with inter connecting hoses								
Puller mechanism	Non-slip double-ended ball type with turrets on either side to facilitate pushing or pulling. Available for E, A, or AQ rods								



Typical Assembly

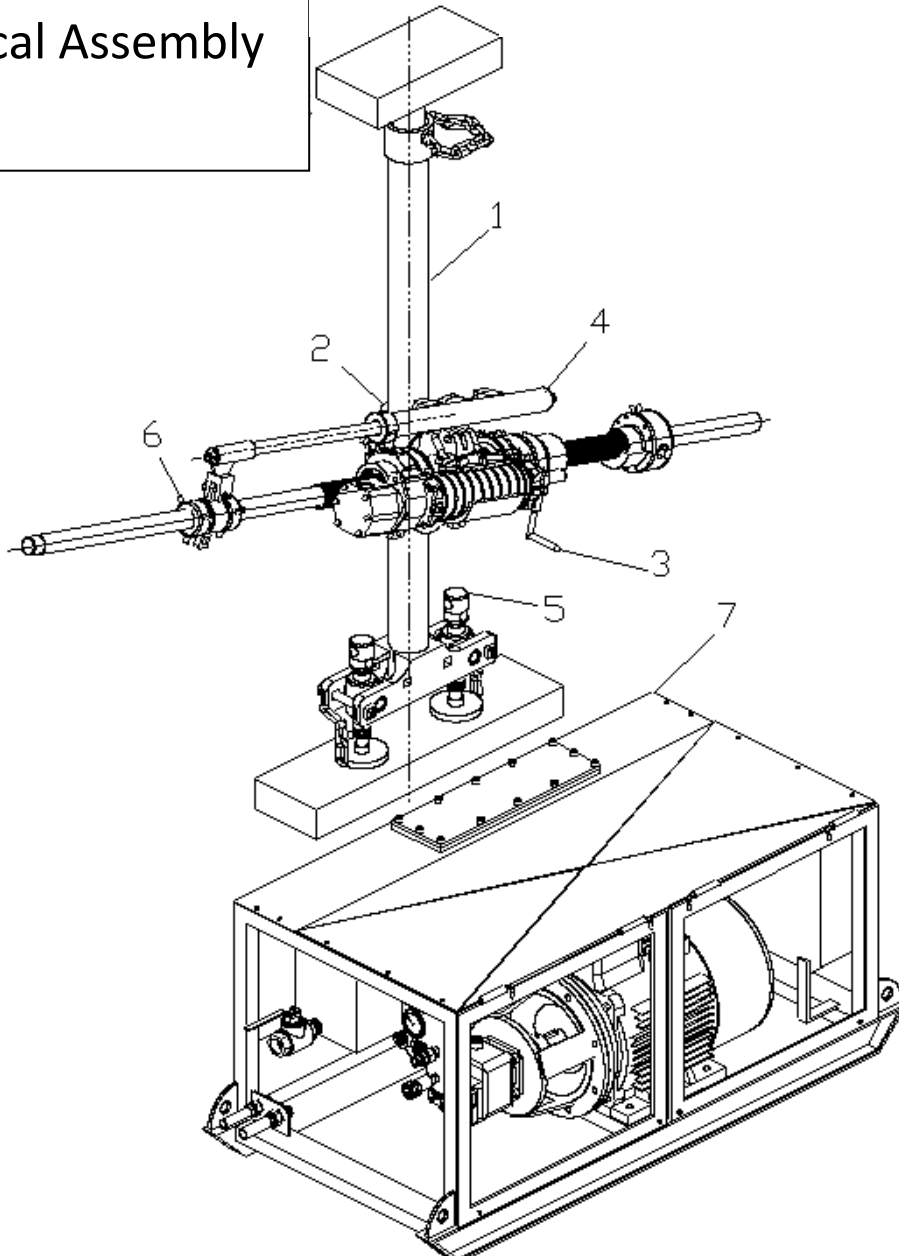

IT	DESCRIPTION	QTY
0	DRILL RIG COMPLETE	1
1	TELESCOPIC POLE ASSEMBLY	1
2	POLE CLAMP ASSEMBLY	1
3	DRILL UNIT ASSEMBLY	1
4	STANDARD HYD. ROD PULLER	1
5	DOUBLE JACK ASSEMBLY	1
6	BALL ROD PULLER ASSEMBLY	1
7	HYDRAULIC POWER PACK	1
8		

